

 US Army Corps of Engineers

 Jacksonville District

 SAFETY ON THIS JOB

 DEPENDS ON YOU

DEPARTMENT OF THE ARMY

 JACKSONVILLE DISTRICT, CORPS OF ENGINEERS

 JACKSONVILLE, FLORIDA

Check By: GHR

 Designed By: WRM

 Drawn By: WRM

 File No: WSP2565-00-0000

 Date: OCT 2021

XXXXXXXXXXXXXXXXXXXX.DGN

 XXXXXXXXXXXXXXXXXXXX.DGN

 XXXXXXXXXXXXXXXXXXXX.DGN

 XXXXXXXXXXXXXXXXXXXX.DGN

 XXXXXXXXXXXXXXXXXXXX.DGN

 XXXXXXXXXXXXXXXXXXXX.DGN

 XXXXXXXXXXXXXXXXXXXX.DGN

 XXXXXXXXXXXXXXXXXXXX.DGN

 XXXXXXXXXXXXXXXXXXXX.DGN

 XXXXXXXXXXXXXXXXXXXX.DGN

 XXXXXXXXXXXXXXXXXXXX.DGN

INTRACOASTAL WATERWAY

 JACKSONVILLE TO MIAMI, FLORIDA

 BREVARD COUNTY

HYDROGRAPHIC EXAM SURVEY FY21

12-FOOT PROJECT

 STA. 18+00 THRU STA. 51+00 CUT BV-23

PLAN

Scale: AS SHOWN

 Drawing no.

64

 SHEET 64 OF 111

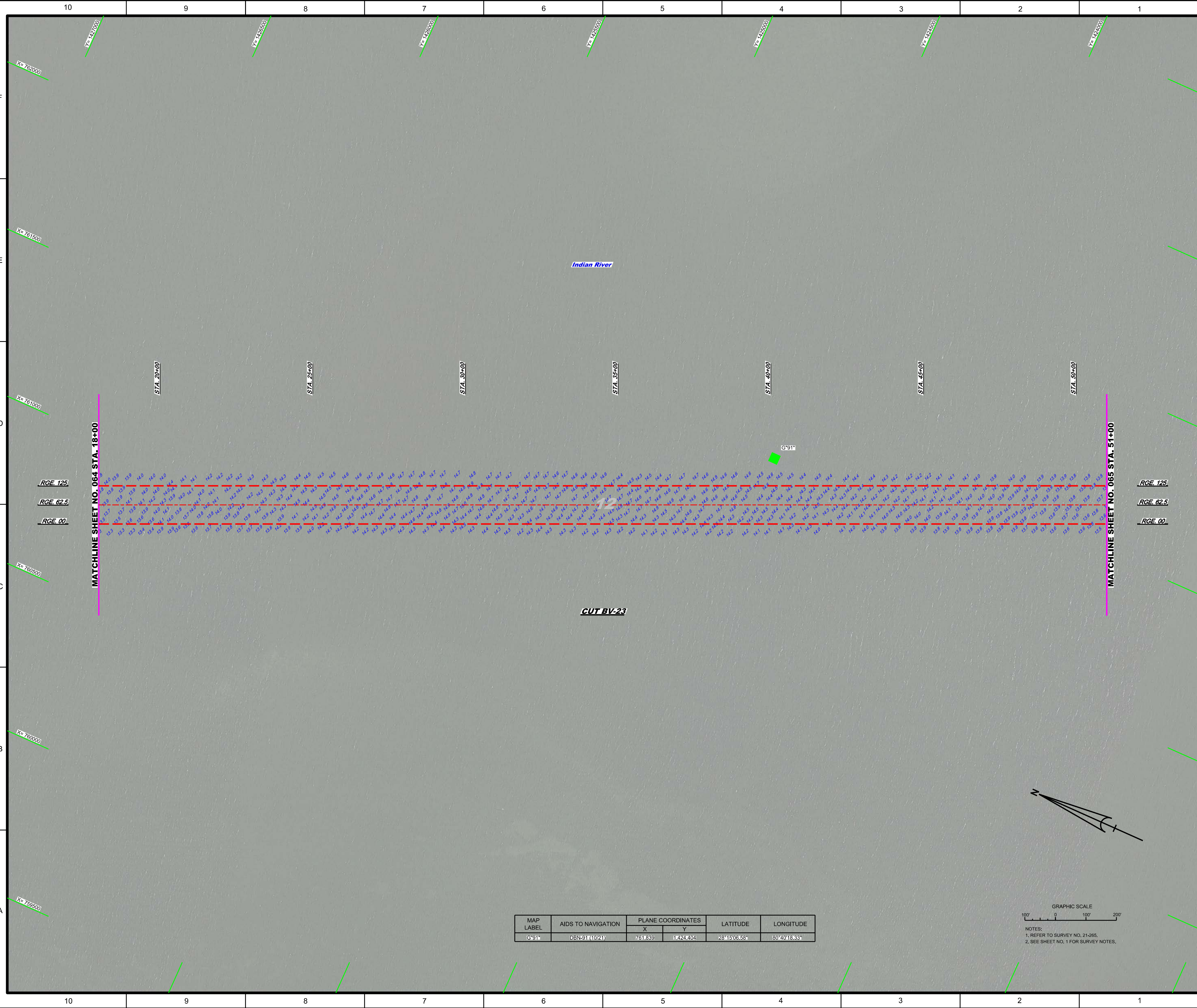

MAP LABEL	AIDS TO NAVIGATION	PLANE COORDINATES		LATITUDE	LONGITUDE
		X	Y		
G*91*	DBN-91 (10/21)	761,839	1,242,404	28°15'06.55"	80°40'18.33"

GRAPHIC SCALE

 100' 0 100' 200'

 NOTES:

 1. REFER TO SURVEY NO. 21-265.

 2. SEE SHEET NO. 1 FOR SURVEY NOTES.

MATCHLINE SHEET NO. 064 STA. 18+00

MATCHLINE SHEET NO. 065 STA. 51+00

CUT BV-23

Indian River

RGE. 125

RGE. 62.5

RGE. 00

RGE. 125

RGE. 62.5

RGE. 00

STA. 20+00

STA. 25+00

STA. 30+00

STA. 35+00

STA. 40+00

STA. 45+00

STA. 50+00

G*91*

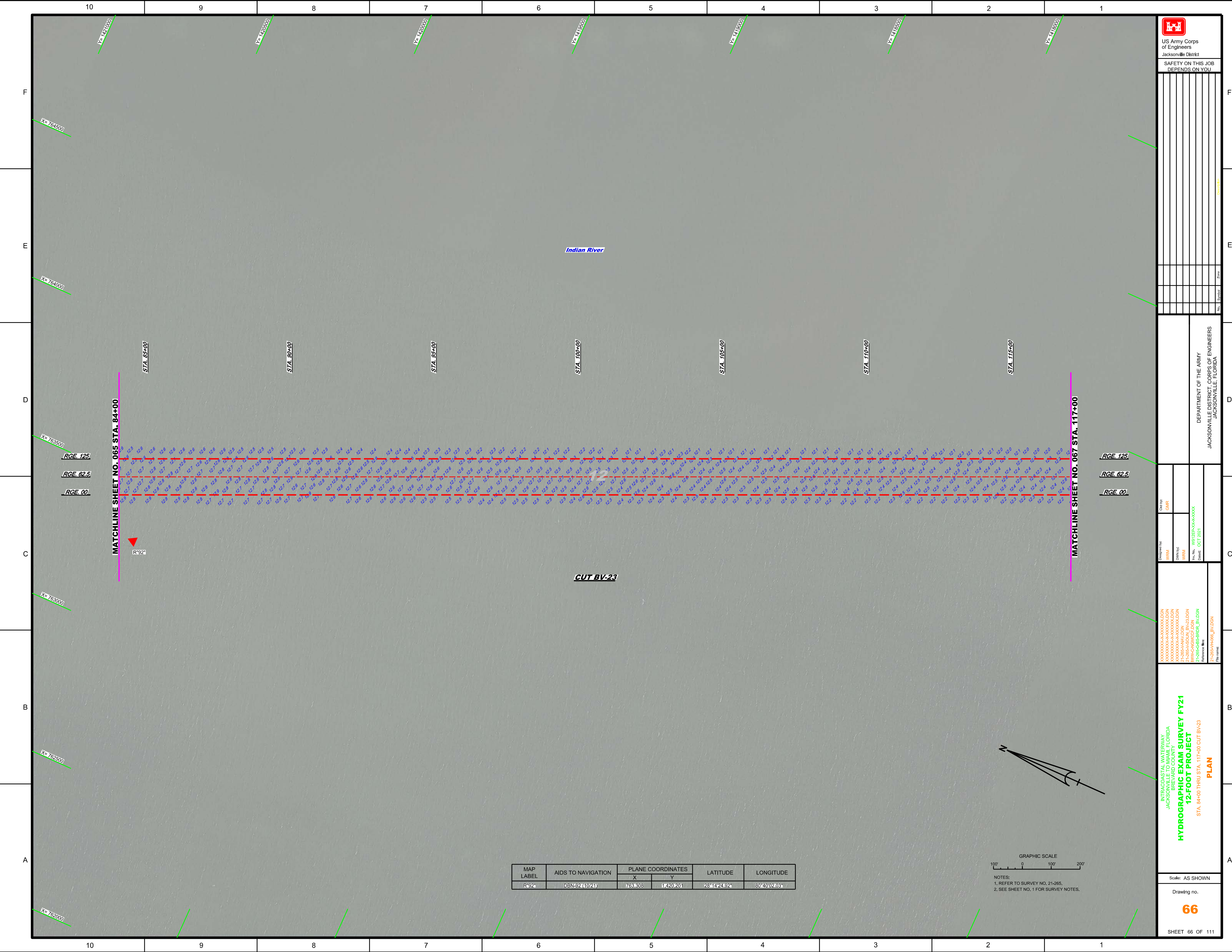



 US Army Corps of Engineers
 Jacksonville District
 SAFETY ON THIS JOB
 DEPENDS ON YOU

No.	Symbol	Zone

DEPARTMENT OF THE ARMY
 JACKSONVILLE DISTRICT, CORPS OF ENGINEERS
 JACKSONVILLE, FLORIDA

Checked by: GHR
 Designed by: WRM
 Drawn by: WRM
 File No.: W37829-3-30-V30-0000
 Date: OCT 2021

XXXXXXXXXXXXXXXXXXXX.DGN
 XXXXXXXXXXXXXXXXXXXX.DGN
 XXXXXXXXXXXXXXXXXXXX.DGN
 21-265-HAWV.DGN
 WACANACE.DGN
 21-265-CB-RRR_BV.DGN
 21-265-HRBE_BV.DGN
 Reference files
 File name:

INTRACOASTAL WATERWAY
 JACKSONVILLE TO MIAMI, FLORIDA
 BREVARD COUNTY
HYDROGRAPHIC EXAM SURVEY FY21
12-FOOT PROJECT
 STA. 84+00 THRU STA. 117+00 CUT BV-23
PLAN

Scale: AS SHOWN
 Drawing no.
66
 SHEET 66 OF 111

MAP LABEL	AIDS TO NAVIGATION	PLANE COORDINATES		LATITUDE	LONGITUDE
		X	Y		
R92	DSN-92(10/21)	768.808	1420.201	28°42'24.92"	80°40'02.03"

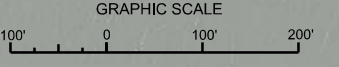

NOTES:
 1. REFER TO SURVEY NO. 21-265.
 2. SEE SHEET NO. 1 FOR SURVEY NOTES.

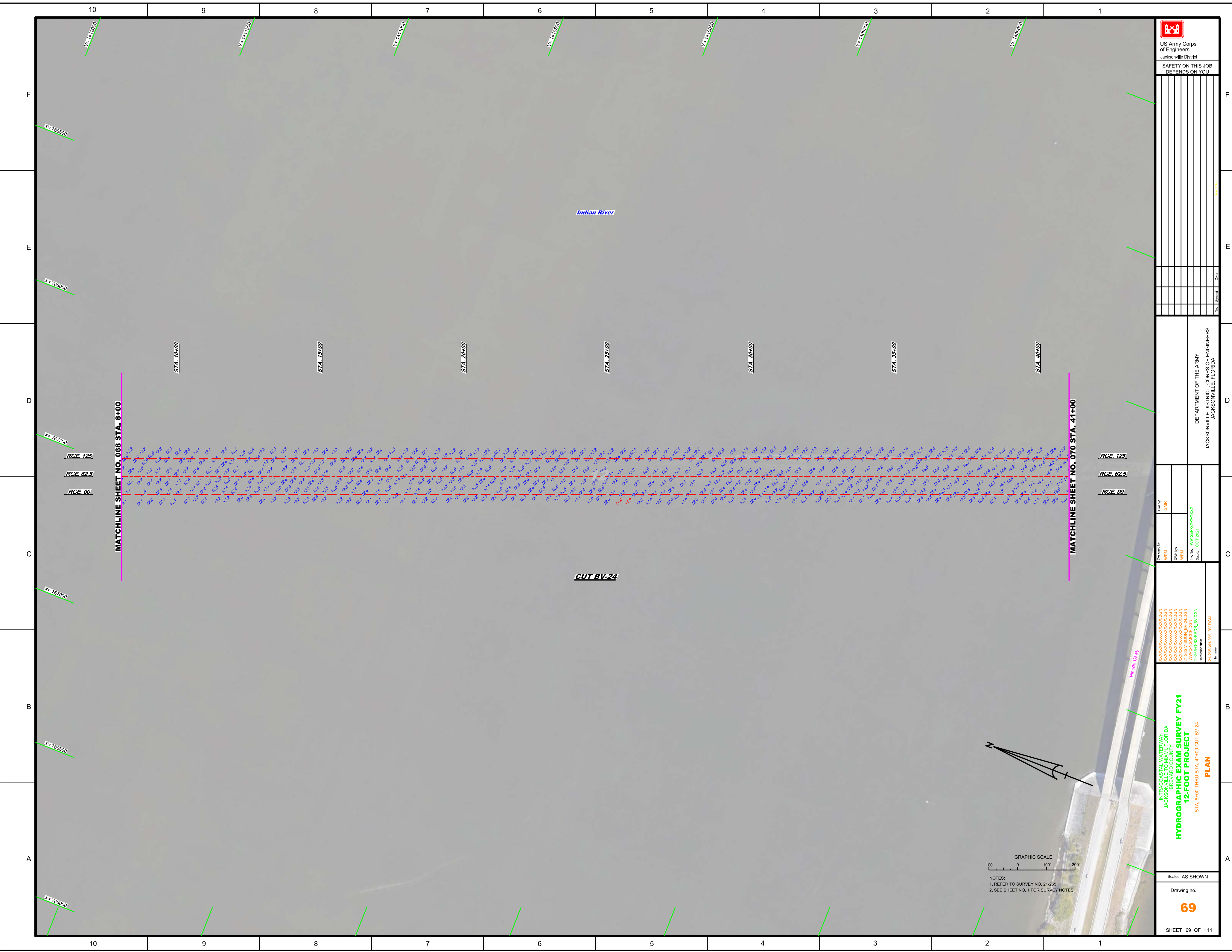

US Army Corps
of Engineers
Jacksonville District
SAFETY ON THIS JOB
DEPENDS ON YOU

Zone	Symbol	Use

DEPARTMENT OF THE ARMY
JACKSONVILLE DISTRICT, CORPS OF ENGINEERS
JACKSONVILLE, FLORIDA

Checked by: GHR
Designed by: WRM
Drawn by: WRM
File No.: W12255-000-0000
Date: OCT 2021
Reference files:
21-265-HY06L_BV.DGN
21-265-HY06L_BV.DGN

INTRACOSTAL WATERWAY
JACKSONVILLE TO MIAMI, FLORIDA
BREVARD COUNTY
HYDROGRAPHIC EXAM SURVEY FY21
12-FOOT PROJECT
STA. 8+00 THRU STA. 41+00 CUT BV24
PLAN

Scale: AS SHOWN
Drawing no.
69
SHEET 69 OF 111

GRAPHIC SCALE
100' 0 100' 200'
NOTES:
1. REFER TO SURVEY NO. 21-265.
2. SEE SHEET NO. 1 FOR SURVEY NOTES.



US Army Corps
of Engineers
Jacksonville District

SAFETY ON THIS JOB
DEPENDS ON YOU

DEPARTMENT OF THE ARMY
JACKSONVILLE DISTRICT, CORPS OF ENGINEERS
JACKSONVILLE, FLORIDA

Drawn By: **WRM**
Checked By: **WRM**
Project No: **WR21255A-V4-V4-0004**
Date: **OCT 2021**

INTRACOASTAL WATERWAY
JACKSONVILLE TO MIAMI, FLORIDA
BREVARD COUNTY
HYDROGRAPHIC EXAM SURVEY FY21
12-FOOT PROJECT
STA. 41+00 THRU STA. 74+00 CUT BV-24
PLAN

Scale: AS SHOWN

Drawing no.

70

SHEET 70 OF 111

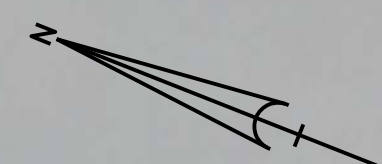
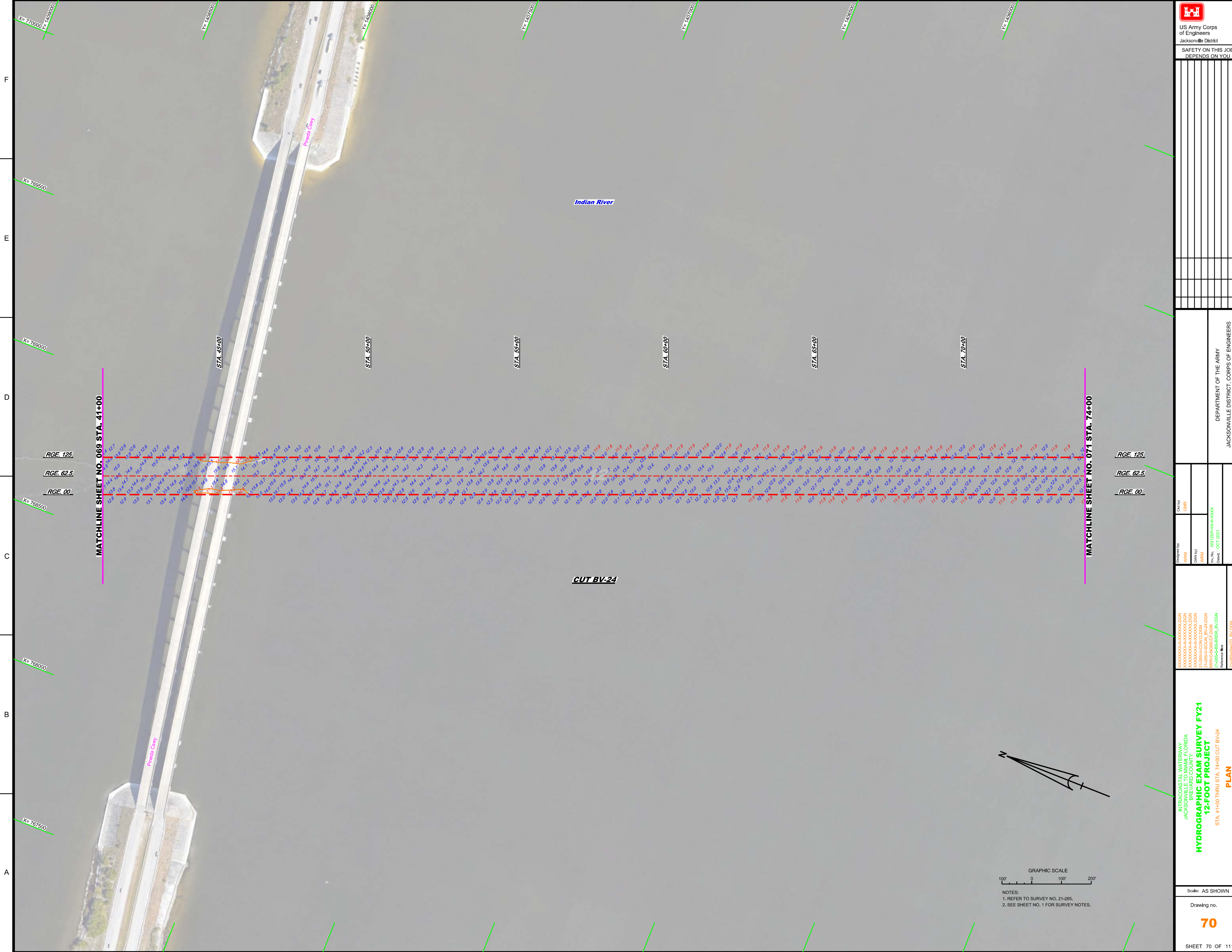

GRAPHIC SCALE
0 100' 200'

NOTES:
1. REFER TO SURVEY NO. 21-265.
2. SEE SHEET NO. 1 FOR SURVEY NOTES.

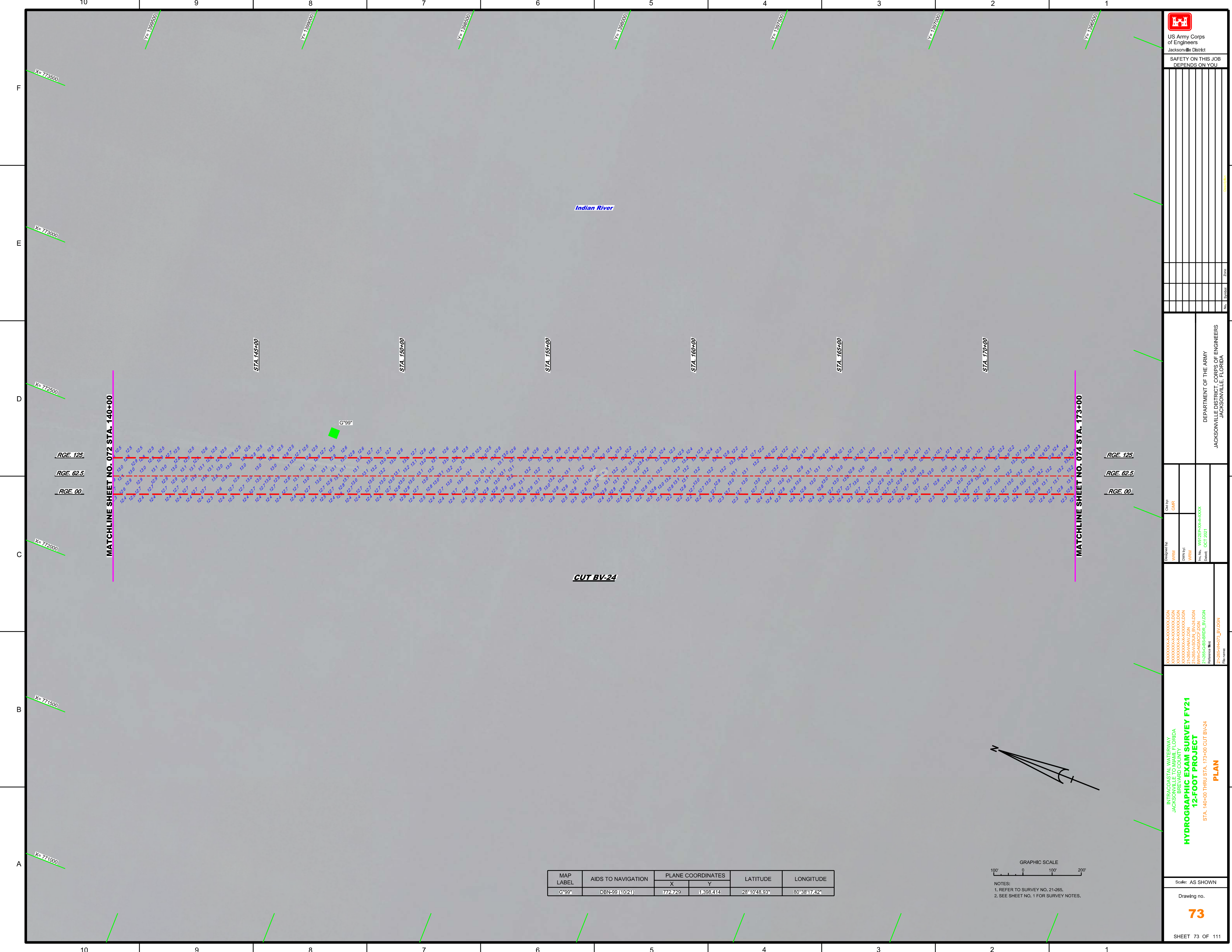

Doc. No.	Symbol	Zone

DEPARTMENT OF THE ARMY
 JACKSONVILLE DISTRICT, CORPS OF ENGINEERS
 JACKSONVILLE, FLORIDA

Check By: GHR
 Designed By: WRM
 Drawn By: WRM
 In File: WRP255-HV7L_BV24
 Date: OCT 2021
 Reference File: 21-265-HV7L_BV24
 File Name:

**INTRACOASTAL WATERWAY
 JACKSONVILLE TO MIAMI, FLORIDA
 BREVARD COUNTY**
**HYDROGRAPHIC EXAM SURVEY FY21
 12-FOOT PROJECT**
 STA. 140+00 THRU STA. 173+00 CUT BV-24
PLAN

Scale: AS SHOWN
 Drawing no. **73**
 SHEET 73 OF 111

MAP LABEL	AIDS TO NAVIGATION	PLANE COORDINATES		LATITUDE	LONGITUDE
		X	Y		
G'99'	DBN-99 (10/21)	772,723	1,398,414	28°10'48.93"	80°38'17.42"

GRAPHIC SCALE
 0 100' 200'
 NOTES:
 1. REFER TO SURVEY NO. 21-265.
 2. SEE SHEET NO. 1 FOR SURVEY NOTES.

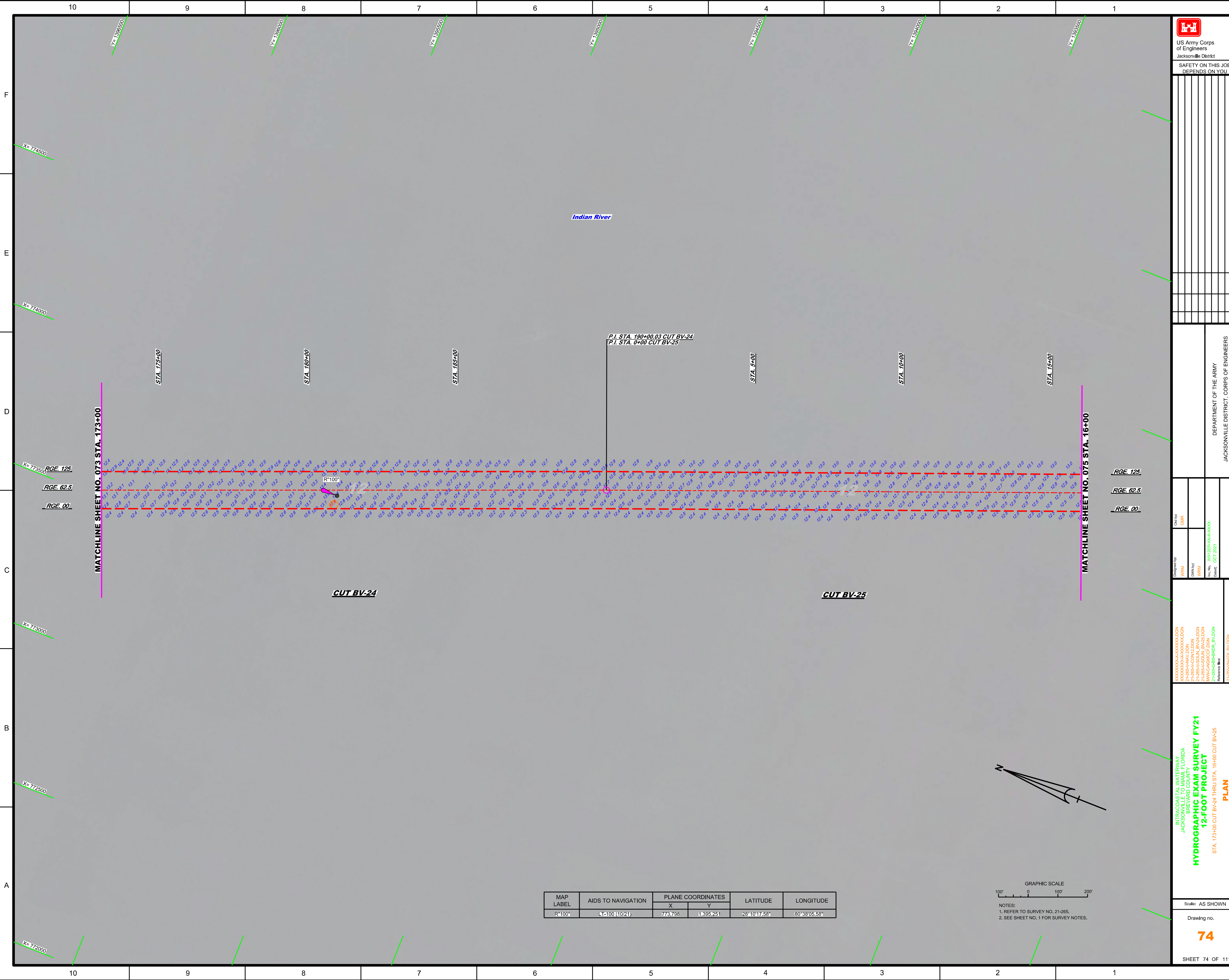

US Army Corps of Engineers
Jacksonville District
SAFETY ON THIS JOB
DEPENDS ON YOU

Matchline: STA. 173+00 Matchline: STA. 16+00	RGE. 125 RGE. 62.5 RGE. 00
---	----------------------------------

Designed by: WRM	Check by: GHR	DEPARTMENT OF THE ARMY JACKSONVILLE DISTRICT, CORPS OF ENGINEERS JACKSONVILLE, FLORIDA
Drawn by: WRM	Date: OCT 2021	
File No.: 21-265-00-001-000	Revision: 1	

INTRA-COASTAL WATERWAY
 JACKSONVILLE TO MIAMI, FLORIDA
 BREVARD COUNTY
HYDROGRAPHIC EXAM SURVEY FY21
12-FOOT PROJECT
 STA. 173+00 CUT BV-24 THRU STA. 16+00 CUT BV-25
PLAN

MAP LABEL	AIDS TO NAVIGATION	PLANE COORDINATES		LATITUDE	LONGITUDE
		X	Y		
R*100"	LT-100 (10/21)	773,798	1,395,251	28°10'17.56"	80°38'05.58"

GRAPHIC SCALE
100' 0 100' 200'

NOTES:
 1. REFER TO SURVEY NO. 21-265.
 2. SEE SHEET NO. 1 FOR SURVEY NOTES.

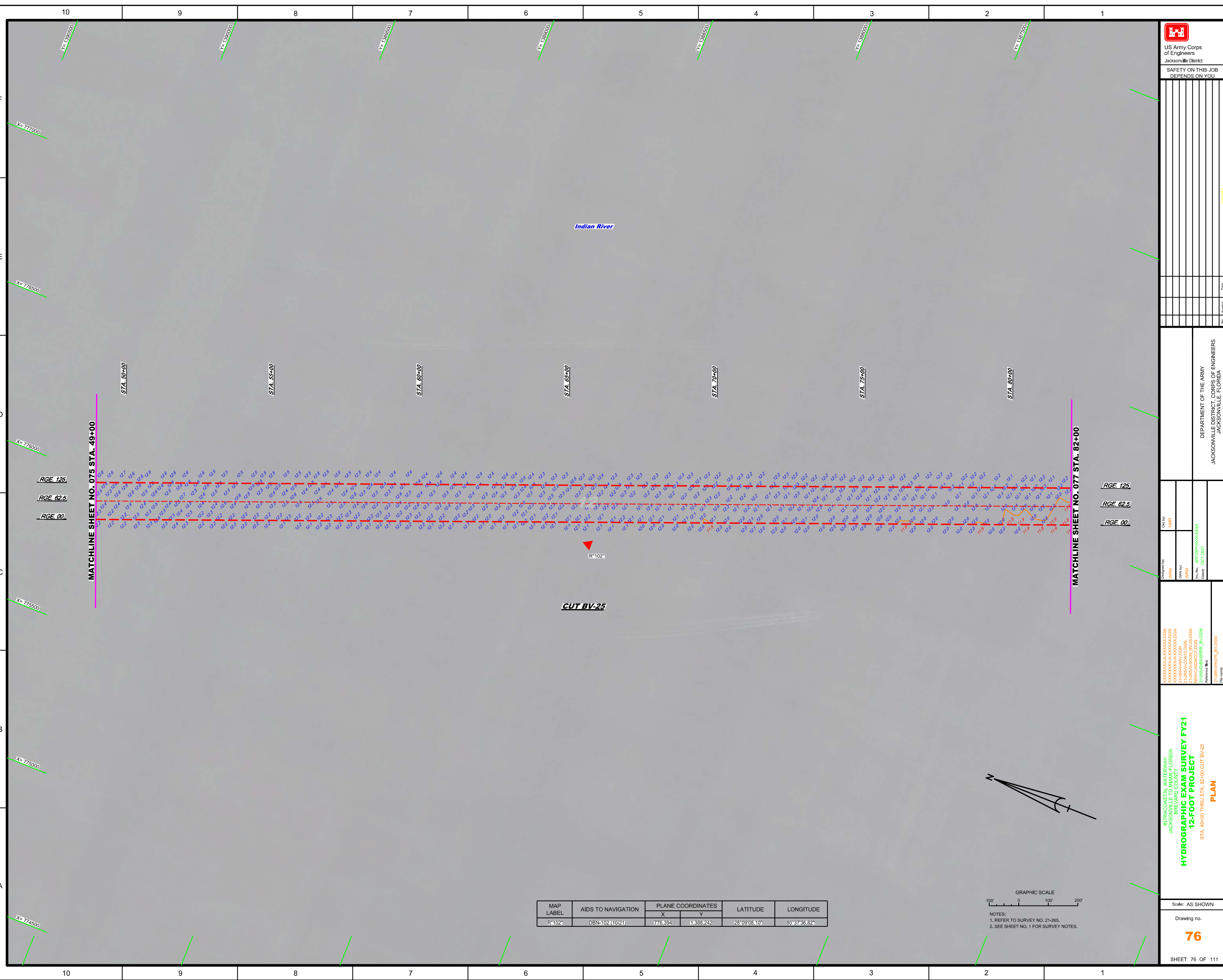

MAP LABEL	AIDS TO NAVIGATION	PLANE COORDINATES		LATITUDE	LONGITUDE
		X	Y		
R*102*	DBN-102 (10/21)	776,394	1,388,242	28°09'08.10"	80°37'36.82"



NOTES:
 1. REFER TO SURVEY NO. 21-265.
 2. SEE SHEET NO. 1 FOR SURVEY NOTES.



 US Army Corps
 of Engineers
 Jacksonville District
 SAFETY ON THIS JOB
 DEPENDS ON YOU

DEPARTMENT OF THE ARMY
 JACKSONVILLE DISTRICT, CORPS OF ENGINEERS
 JACKSONVILLE, FLORIDA

Drawn by: GHR
 Checked by: WRM
 Designated by: WRM
 Date: OCT 2021
 File Name: WJ2255-00-BV25
 Reference files:
 21-265-00-BV25.dgn
 21-265-00-BV25.dgn
 21-265-00-BV25.dgn
 21-265-00-BV25.dgn
 21-265-00-BV25.dgn
 21-265-00-BV25.dgn
 21-265-00-BV25.dgn
 21-265-00-BV25.dgn

INTRACOASTAL WATERWAY
 JACKSONVILLE TO MIAMI, FLORIDA
 BREVARD COUNTY
HYDROGRAPHIC EXAM SURVEY FY21
12-FOOT PROJECT
 STA. 82+00 THRU STA. 115+00 CUT BV/25
PLAN

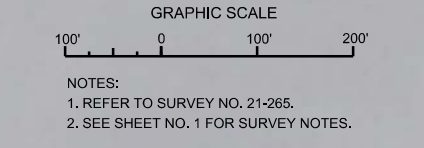
Scale: AS SHOWN
 Drawing no.
77
 SHEET 77 OF 111



NOTES:
 1. REFER TO SURVEY NO. 21-265.
 2. SEE SHEET NO. 1 FOR SURVEY NOTES.

